

# KP3504TF



Incorporated into fire, smoke and life safety door assemblies to provide resistance against all stages of fire and smoke whilst also providing excellent acoustic properties.

## Key Features

- Dual offset fin seals (TF) provides outstanding smoke and sound containment properties.
- Provides an ideal alternative for double swing pivot door assemblies, where the smoke seal can remain uninterrupted while the seal body is checked to allow for any door hardware.
- Simple self-adhesive / screw-fix application onto the bottom of the door.

## Use With

Used in conjunction with a Kilargo 4000 Series threshold plate to provide a total door bottom sealing solution.

## Materials

High performance intumescent core with a rigid PVC casing combined with dual elastomeric smoke and acoustic fins. Supplied with aggressive self adhesive backing.

## Gap Size

10mm (dependent upon installation)

## Standard lengths

820mm, 920mm, 1220mm  
Other lengths to special order

## Standard fin height

9mm

## Standard colour

- Black

## Fixing

The product is fitted to the underside of the door leaf using the aggressive self-adhesive backing tape and simple screw-fixing.

## Approval/s

- Fully tested to AS1530 Part 4 for up to 2 hours on proprietary fire door assemblies in accordance with AS1905 Part 1
- Medium temperature smoke leakage approvals to AS1530 Part 7, compliant with AS6905 on proprietary door assemblies
- Conforms with BCA Specification C3.4 smoke sealing requirements
- Acoustically tested in accordance with AS1191, ISO140.3 & ISO10140-2.



KP3504TF

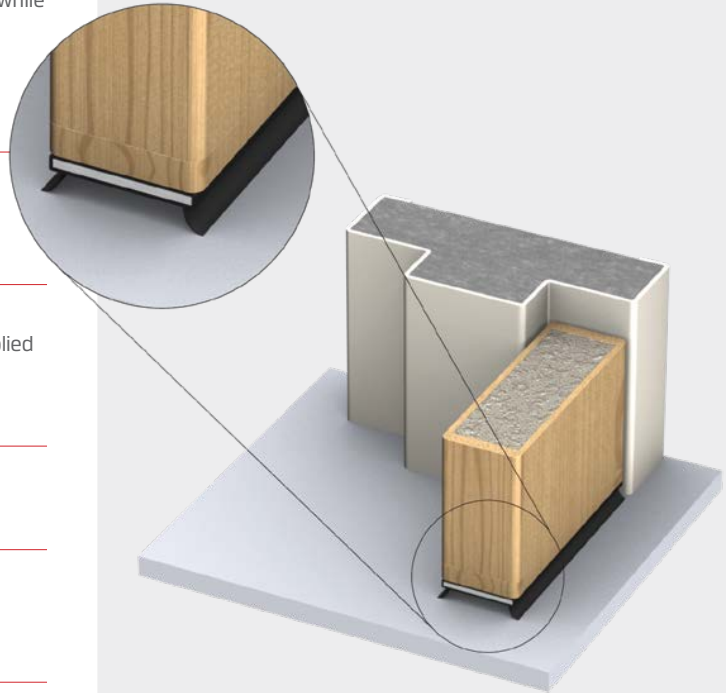

Kilargo KP3504TF | Last edit 21/11/2019

15 Wentworth Pl, Banyo QLD 4014, Australia  
P +61 7 3635 5000 F +61 7 3861 9266 E sales@kilargo.com.au W kilargo.com.au