

Product Fact Sheet

KP1504TS, KP2004TS

Description

KP-TS Series combined intumescent fire and smoke seals.

Application

High performance sodium silicate based intumescent fire and smoke seal. The intumescent core is encapsulated in a flame-retardant PVC outer casing with centrally located twin smoke and acoustic fins. Incorporated into the perimeter of fire door assemblies. When exposed to fire conditions, these intumescent strip seals expand to many times their original volume, sealing off the door perimeter to prevent the passage of hot smoke and other toxic gases.

Key Features

- One seal only for fire and all temperatures of smoke.
- Rebated into the door or frame for longevity in service.
- Decorative and protective PVC outer casing.
- Ideal for fire engineered solutions where extra protection is necessary for life safety.

Materials

High performance sodium silicate based intumescent core encapsulated in a rigid flame retardant PVC outer casing with coextruded twin sealing fins. Supplied with aggressive self adhesive backing.

Gap Size

Minimum 2mm - Maximum 3mm

The product sits flush with the edge of the door leaf or door frame edge.

Sizes

Standard lengths: 1000mm, 2100mm, 2400mm, 2700mm, 3000mm

Standard fin height: 4mm

Finish

■ Standard Colour: Black, Grey

Fixing

The product is fitted into a groove in the door frame or the edge of the door leaf and is fixed using the self-adhesive tape backing.

Approval/s

- Fully tested to AS1530 Part 4 for up to 2 hours on proprietary fire door assemblies in accordance with AS1905 Part 1
- Medium temperature smoke leakage approvals to AS1530 Part 7 available on proprietary door assemblies
- Conforms with NCC Specification C3.4 smoke sealing requirements
- Acoustically tested in accordance with AS1191, ISO140.3 & ISO10140-2
- Independent tests have been conducted demonstrating over 100,000 open and close cycles without significant wear.



All measurements in millimetres. © Copyright Kilargo Pty Ltd.
Kilargo reserves the right to alter published data or make products obsolete without prior notice.

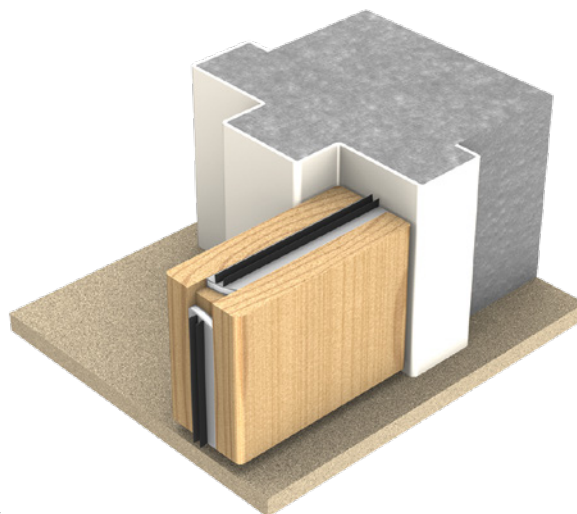
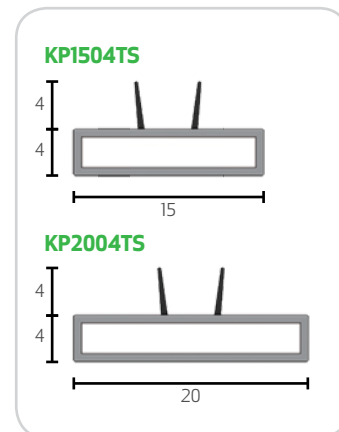
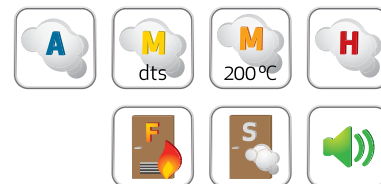

Above:

KP1504TS intumescent fire and smoke seal rebated into a door perimeter.