

FITTING METHOD 1

Vermiculux / Promatect board screw fixed to 50 x 50 x 1mm continuous angle with 7 gauge x 65mm screws. Angle fixed to concrete slab with M6.5 masonry anchors.

FITTING METHOD 2

Vermiculux / Promatect board screw fixed to 60 x 52mm Vermiculux or Promatect cleat with 7 gauge x 90mm screws. Cleat fixed to concrete slab with M6.5 masonry anchors.

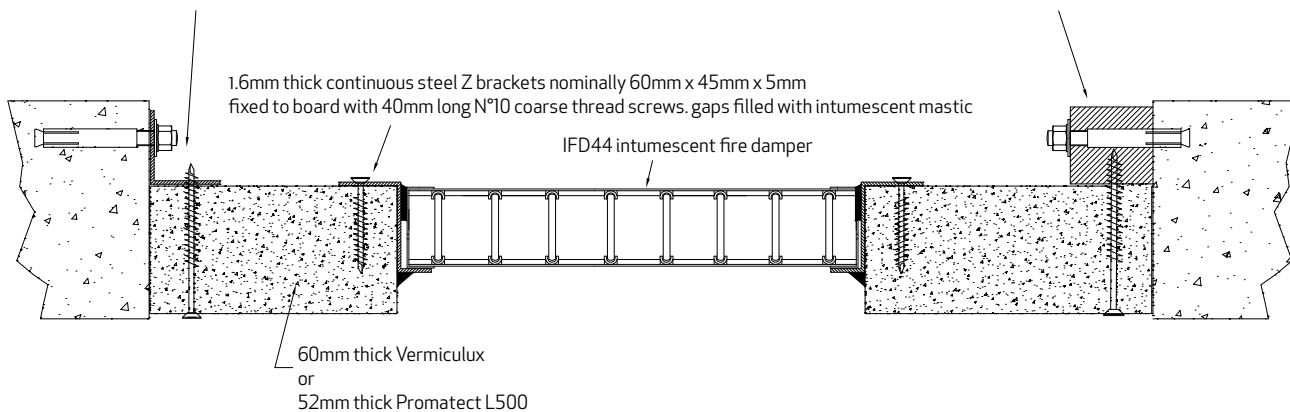

Note: This system is NON-LOADBEARING and if used in a trafficable area appropriate signage and were necessary a load bearing grate should be utilised to minimise the risk of injury arising from persons walking upon it.

Installation Instructions

IFD44 mounted in Vermiculux board within concrete floor slab

1. Position damper as detailed in the System Drawing.
2. If applicable, position & fasten Z Brackets using screws & anchors (all supplied by others) as detailed in the System Drawing.
3. First stop any gaps between the damper, brackets & board (as shown) with Kilargo Intumescent Mastic (supplied separately). Ensure fill depth corresponds with those detailed in the System Drawing.
4. Cut Vermiculux / Promatect board to size and fix (using Fitting Method 1 or 2) to concrete slab with masonry anchors (all supplied by others) as detailed in the System Drawing.
5. If connecting ductwork, ensure that an appropriate AS1682.2 compliant breakaway joint method is used.
6. Ensure convenient access is provided for visual inspection and cleaning as necessary.
7. Ensure product and certification labels are in a prominent position for easy identification during subsequent maintenance inspections.

Notes

1. Product must be fitted in accordance with this detail, including the use of Kilargo Intumescent Mastic to ensure compliance with Kilargo Fire Test Approval detailed.
2. Fixing screws, angles, Vermiculux / Promatect board and anchors are to be supplied by others.



Building Element	Vermiculux Board
Application	Retrofit/Upgrade - IFD mounted in 60mm thick Vermiculux board protecting aperture in floor slab
Maximum Size	800mm x 800mm
FRL	-/120/-
Test Reference No.	BRANZ FAR3963
System No.	FLV1