

Installation Instructions

Single cell IFD44 penetrating 16mm FR Plasterboard wall (no casing)

1. Depending upon fixing bracket chosen, fasten mounting Angle Tab or Z brackets to one side of damper with steel self drilling screws or steel pop rivets.
2. Position damper centrally in penetration aperture as per system drawing
3. Fix mounting Angle Tab or Z bracket to wall aperture using screws (supplied by others).
4. Fire-stop any gaps between the damper & building element with Kilargo Intumescent Mastic (supplied separately). Ensure fill depth corresponds with those detailed in the System Drawing.
5. If connecting ductwork to wall ensure that an appropriate AS1682.2 compliant breakaway joint method is used.
6. Ensure product and certification labels are in a prominent position for easy identification during subsequent maintenance inspections.
7. Ensure convenient access is provided for visual inspection and cleaning as necessary.

Notes

1. Product must be fitted in accordance with this detail, including the use of Kilargo Intumescent Mastic to ensure compliance with Kilargo Fire Test Approval detailed.
2. Fixing screws, brackets and anchors are to be supplied by others.

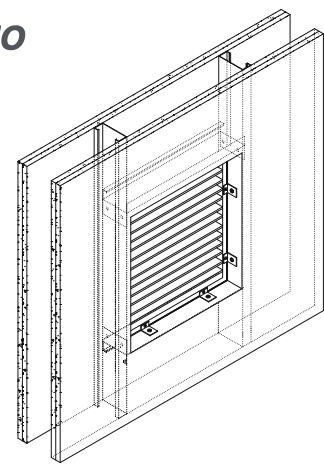

Building Element 16mm FR Plasterboard x 2 layers

Application NO casing in penetration

Maximum Size 2400mm x 2400mm or 5.76m²

FRL -/120/-

Test Reference No. FAS200142

System No. **WP7**